

# Photo-electric sensors

Osiris® Application, tertiary sector series  
With integral buzzer  
a.c. or d.c. supply. 1 "N/O" relay output

Compact design

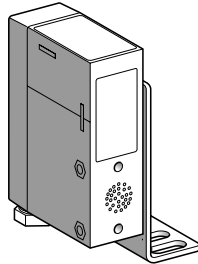

<b>System</b>	<b>Reflex</b>
<b>Type of transmission</b>	Infrared
<b>Nominal sensing distance (Sn)</b>	<b>6 m (with Ø 80 mm reflector)</b>
<b>Output cable gland</b>	9 mm plastic, mounted in base

## References

Dark switching	<b>XUJ B06031H60</b> (supplied as kit, comprising: photo-electric sensor, fixing bracket, Ø 80 mm reflector and mounting instructions)
Weight (kg)	0,330

## Characteristics

<b>Product certifications</b>	CE
<b>Ambient air temperature</b>	Operation: - 25...+ 55 °C. Storage: - 40...+ 70 °C
<b>Vibration resistance</b>	7 gn, amplitude ± 1.5 mm (f = 10...55 Hz), conforming to IEC 60068-2-6
<b>Shock resistance</b>	30 gn, duration 11 ms, conforming to IEC 60068-2-27
<b>Degree of protection</b>	IP 40 conforming to IEC 529 and IP 401 conforming to NF C 20-010 / □ double insulated
<b>Connection</b>	Screw terminals, capacity: 1 x 1.5 mm <sup>2</sup>
<b>Materials</b>	Case: PEI (1)
<b>Rated supply voltage</b>	~ 24...240 V or = 24...48 V
<b>Voltage limits</b>	~ 20...264 V or = 20...60 V (including ripple)
<b>Switching capacity</b>	<b>2000 mA (cos φ = 1), 500 mA (cos φ = 0.4) for a contact life of 1 million operating cycles at an operating rate of 1 operating cycle per second, at 250 V</b>
<b>Maximum voltage on output relay contacts</b>	~ 250 V or = 30 V
<b>Current consumption, no-load</b>	≤ 30 mA
<b>Maximum switching frequency</b>	20 Hz
<b>Delays</b>	First-up: ≤ 60 ms ; response: ≤ 25 ms ; recovery: ≤ 25 ms
<b>Time delay</b>	Adjustable from 0.3 to 3 seconds

Function table	Function	Reflex system	
		No object present in the beam	Object present in the beam
Output state of relay contacts indicator: yellow LED (illuminated when relay energised)	Dark switching	 Relay de-energised      yellow	 Relay energised      yellow

(1) PEI: high quality synthetic resin providing excellent withstand to shocks, vibration and the effects of external agents frequently encountered in industry: alcohol, salts, petroleum, oils, grease, washing agents (diluted sodium carbonate 4 %, nitric acid 2 %), formaldehyde vapour, splashing lactic acid, etc.

# Photo-electric sensors

Osiris® Application, tertiary sector series  
With integral buzzer  
a.c. or d.c. supply. 1 "N/O" relay output

## Detection curve

Reflex system

Ø of beam  
cm

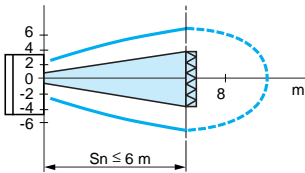

## Contents of kit XUJ B06031H60:

- reflex system photo-electric sensor,
- fixing bracket,
- Ø 80 mm reflector,
- mounting instructions.



## Excess gain curve (ambient temperature: + 25 °C)

Infrared reflex system

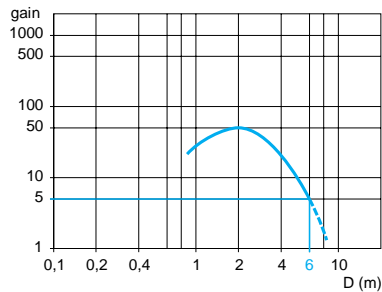

With reflector XUZ C80

## Dimensions

XUJ B06031H60

Face view

Bracket fixing

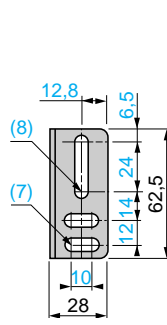
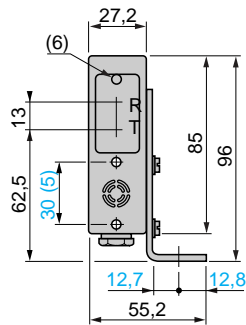
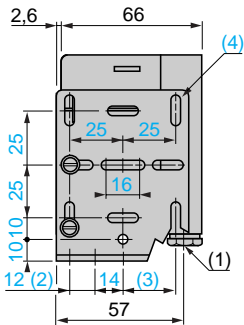

(1) n° 9 plastic cable gland

(2) 2 elongated holes Ø 6.5 x 10

(3) 1 elongated hole Ø 6.5 x 24

(4) 8 elongated holes Ø 4.2 x 10

(5) Front fixing (Ø 4 screws and inserts supplied)

(6) Yellow LED

(7) 2 elongated holes Ø 6.5 x 16.5

(8) 1 elongated hole Ø 6.5 x 30.5

## Wiring schemes (∩ or ∩∩)

Dark switching

Object present

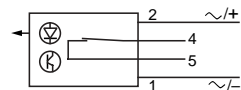

## Terminal connections

1 C/O relay output

1 Ø - A1 (∩/-)

2 Ø - A2 (∩/+)

3 Ø -

4 Ø - ∩ 250 V, 100 VA

5 Ø - ∩∩ 30 V, 2 A max