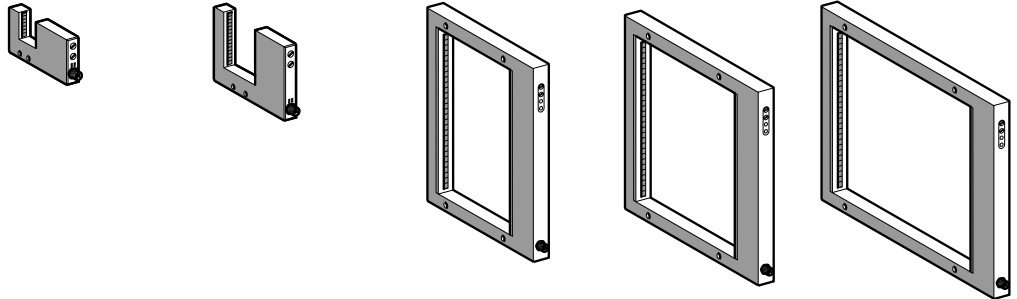

Photo-electric sensors

Osiris® Application, assembly series
Dynamic detection of passage of objects, counting parts (1)
d.c. supply. Solid-state output

Frame design



System	Thru-beam				
Type of transmission	Infrared				
Passageway dimensions	30 x 30 mm	60 x 60 mm	200 x 120 mm	200 x 180 mm	200 x 250 mm

References

3-wire, PNP and NPN	Output function ON or OFF on passage of object, programmable	XUV F30M8	XUV F60M8	XUV F120M12	XUV F180M12	XUV F250M12
Weight (kg)		0.080	0.140	1.060	1.200	1.320

Characteristics

Product certifications	CE	
Ambient air temperature	Operation : 0...+ 60 °C. Storage : - 20...+ 80 °C	
Vibration resistance	25 gn, amplitude ± 2 mm (f = 10...55 Hz), conforming to IEC 60068-2-6	
Shock resistance	30 gn, duration 11 ms, conforming to IEC 60068-2-27	
Degree of protection	IP 65 conforming to IEC 60529	
Connection	M8 male connector (suitable female extension cables, see page 30210/2)	M12 male connector (suitable extension cables and female connectors, see page 30210/2)
Materials	Case : painted aluminium ; lenses : polycarbonate	
Immunity to ambient light	Sunlight : 4000 lux max., incandescent light : 400 lux max.	
Minimum size of object detected	Ø 2 mm	Ø 4 mm
Passing speed of object	Min. : 10 cm/s, max. : 15 m/s (Ø 2 mm object)	Min. : 10 cm/s, max. : 15 m/s (Ø 4 mm object)
Rated supply voltage	≡ 24 V with protection against reverse polarity	
Voltage limits	≡ 18...30 V (including ripple)	
Switching capacity (sealed)	≤ 100 mA with overload and short-circuit protection	
Voltage drop, closed state	< 2 V	
Current consumption, no-load	≤ 120 mA	≤ 400 mA
Maximum switching frequency	500 Hz	
Delays	First-up : ≤ 100 ms ; response : < 1 ms ; recovery : < 1 ms	
Time delay	Off-delay (reset) adjustable between 0 and 5 seconds	

Function table	Function	Thru-beam system	
		No object present in the beam	Passage of object through the beam
Output state (PNP or NPN) indicator : green LED (illuminated when detector output is ON)	Output OFF on passage of object		
	Output ON on passage of object		

(1) **XUV F** sensors are suitable for detecting the passage of all types of objects (both metal and plastic, of any shape and colour) providing the flow is dynamic. Applications : counting parts, flow control of injection machine parts, etc.

Photo-electric sensors

Osiris® Application, assembly series
Dynamic detection of passage of objects, counting parts
d.c. supply. Solid-state output

Presentation XUV F30M8

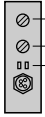

XUV F●●0M12

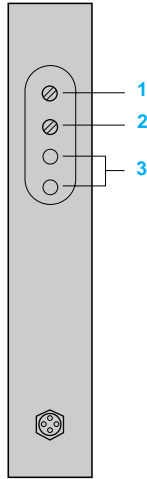

- 1 Sensitivity adjustment potentiometer.
- 2 Time delay adjustment potentiometer.
- 3 Indicators :

Green LED : output
Red LED : alarm

Notes :

- in the event of a supply malfunction, the red LED flashes,
- in the event of a short-circuit on the output, both the red and green LEDs flash.

XUV F60M8

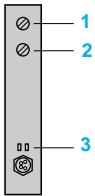

Dimensions XUV F30M8

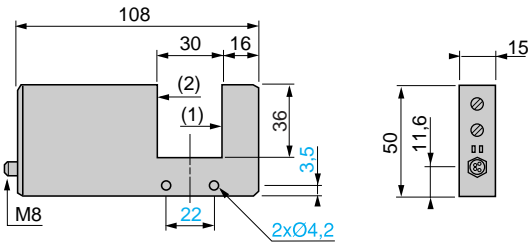

XUV F60M8

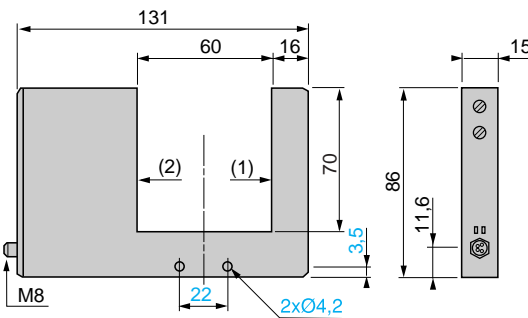

XUV F●●0M12

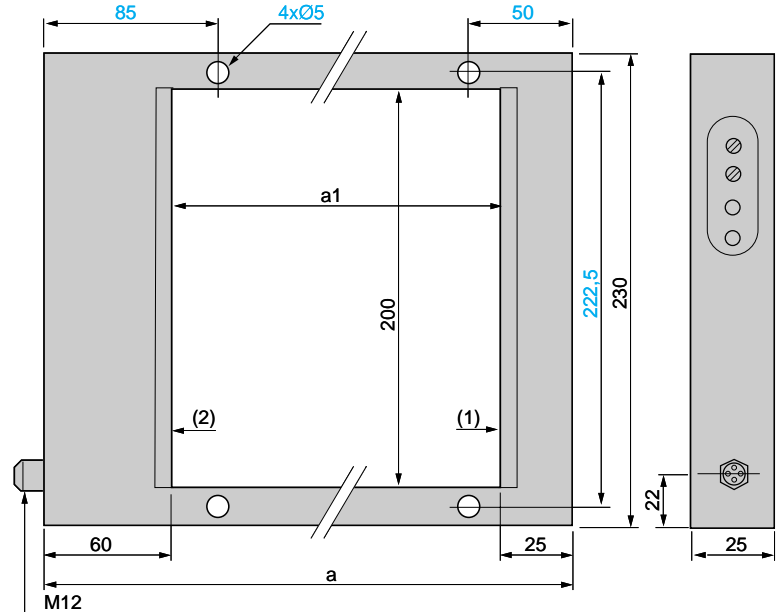

XUV	a	a1
F120M12	205	120
F180M12	265	180
F250M12	335	250

- (1) Transmitting face
- (2) Reception face

Wiring schemes (3-wire ---)

Output ON on passage of object programmed (1)
PNP output NPN output

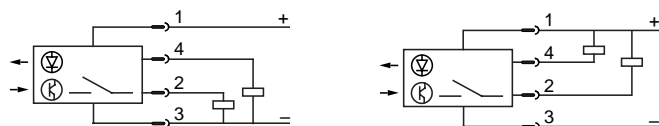

Connector schemes (detector connector pin view)

Output ON on passage of object programmed (1)
XUV F●●0M8 XUV F●●0M12

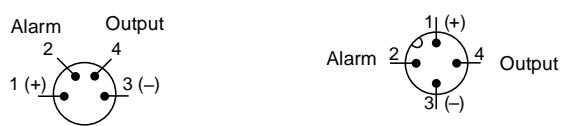

Depending on connector page 30210/2

Note: the alarm (2) triggers in the event of an object stopping within the beam.

(1) To program the detector for output OFF on passage of object, connect contact 3 to (+) and contact 1 to (-).