

Photo-electric sensors

Fibre optic light guides for Osiris® Optimum and Universal amplifiers
Accessories



XUF Z02



XUF Z01

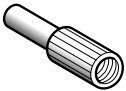

XUF Z06

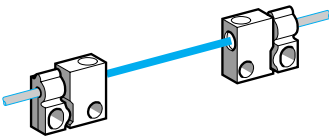

XUF Z13, XUF Z03

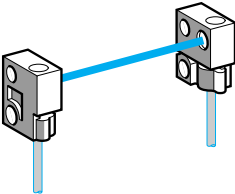

XUF Z14, XUF Z04

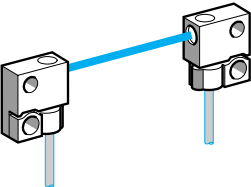

XUF Z15, XUF Z05

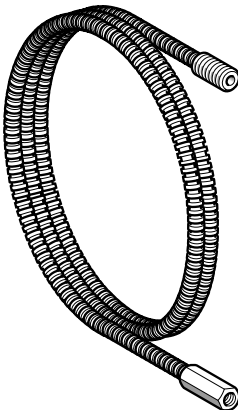

XUF Z10

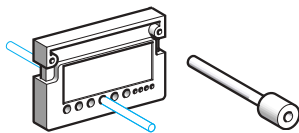

XUF Z11

XUF Z08

Accessories for fibre optic light guides with threaded end fittings

Description	Application	Reference	Weight kg
90° mirror (set of 2)	Fibre optic light guides XUF N1●30●, XUF N35301 and XUF S2020 (thru-beam system)	XUF Z02	0.005
Lenses for increasing sensing distance (set of 2)	Fibre optic light guides XUF N1●30●, XUF N35301 and XUF S2020 (thru-beam system)	XUF Z01	0.005
Focusing lens for high precision detection. Detection of 0.5 mm objects at a distance of 7 mm. Also allows detection of objects in the presence of a background (1)	Fibre optic light guides XUF N02323	XUF Z06	0.001

Accessories for plastic fibre optic light guides without end fittings

Description	Mounting plane	Application	Reference	Weight kg
Fixing clamps (set of 2)	Axial	Plastic fibre optic light guides XUF Z	XUF Z13	0.002
	Frontal	Plastic fibre optic light guides XUF Z	XUF Z14	0.002
	Lateral	Plastic fibre optic light guides XUF Z	XUF Z15	0.002
Fixing clamps with lens (set of 2)	Axial	Plastic fibre optic light guides XUF Z	XUF Z03	0.002
	Frontal	Plastic fibre optic light guides XUF Z	XUF Z04	0.002
	Lateral	Plastic fibre optic light guides XUF Z	XUF Z05	0.002

Protection accessories

Description	Application	Reference	Weight kg
Protective tubing Length 1 m	Plastic fibre optic light guides with M4 threaded end fittings	XUF Z210	0.040
	Plastic fibre optic light guides with M6 threaded end fittings	XUF Z310	0.065

Other accessories

Description	Sold in lots of	Unit reference	Weight kg
Fibre trimmer	1	XUF Z11	0.006
Plastic adaptor, for connecting Ø 1mm fibres to XUD A amplifiers (1) Characteristics obtained when the fibre is fully screwed into the lens (screwing depth = 4 mm).	2	XUF Z08	0.002

References of fibre optic light guides:
pages 30131/2 to 30131/9

Detection curves for plastic fibre optic light guides with fixing clamps

Sensing range of fibres XUF Z9●●● fitted with fixing clamps XUF Z●●

Fibre type	Clamp type	Sensing range				
		XUF Z13	XUF Z14, Z15	XUF Z03	XUF Z04, Z05	Without clamp
XUF Z910, Z920 (2 fibres L = 2 m)	Sn	150 mm	100 mm	800 mm	600 mm	200 mm
XUF Z911, Z921 (2 fibres L = 2 m)	Sn	220 mm	150 mm	1200 mm	900 mm	300 mm

Other fibre lengths:

5 m fibres: reduce the sensing distance by a factor of 0.7

10 m fibres: reduce the sensing distance by a factor of 0.5

20 m fibres: reduce the sensing distance by a factor of 0.3

Detection curves with lens

Fixing clamp XUF Z03, Z04 or Z05
+ fibre XUF Z910 or Z920

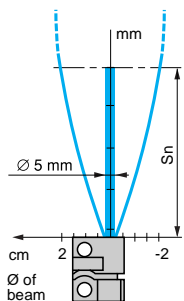

Fixing clamp XUF Z03, Z04 or Z05
+ fibre XUF Z911 or Z921

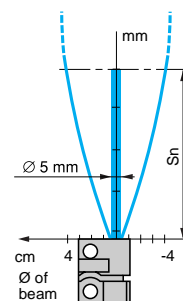

Detection curves without lens

Fixing clamp XUF Z13, Z14 or Z15
+ fibre XUF Z910 or Z920

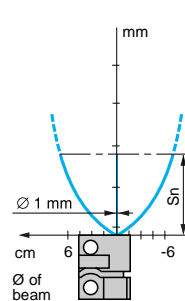

Fixing clamp XUF Z13, Z14 or Z15
+ fibre XUF Z911 or Z921

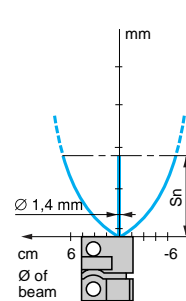

Dimensions

XUF Z01

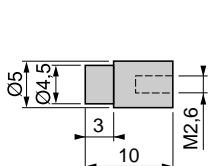

XUF Z210

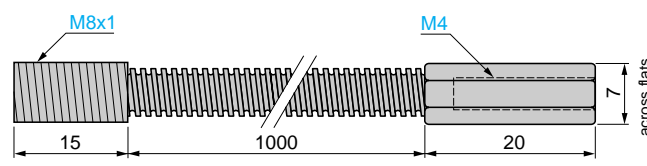

XUF Z06

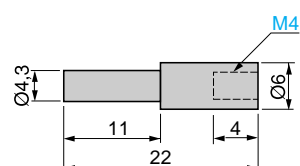

XUF Z02

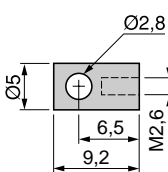

XUF Z310

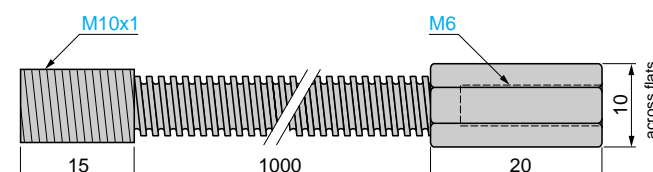

XUF Z03, XUF Z13

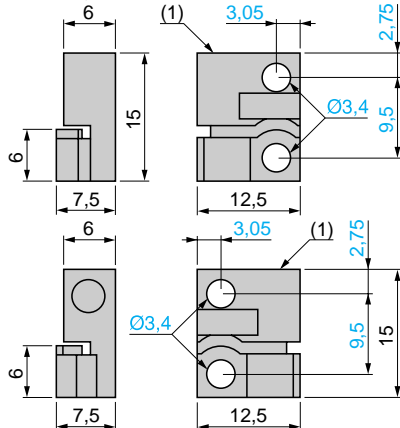

XUF Z04, XUF Z14

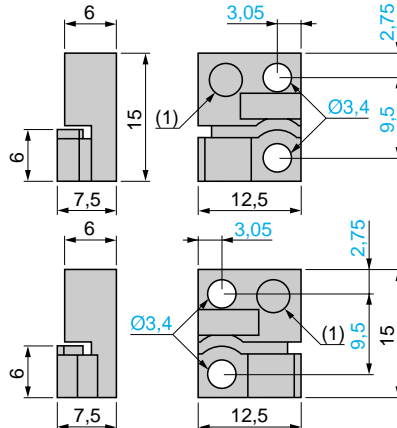

XUF Z05, XUF Z15

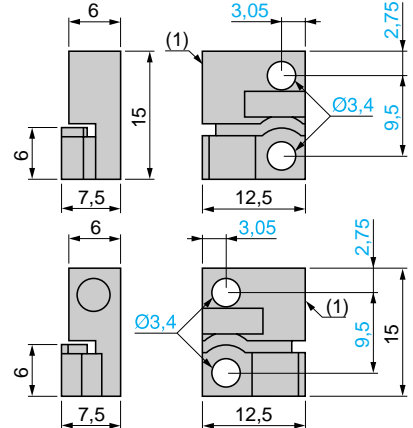

(1) Light beam window

References of fibre optic light guides:
pages 30131/2 to 30131/9